

Soils Map

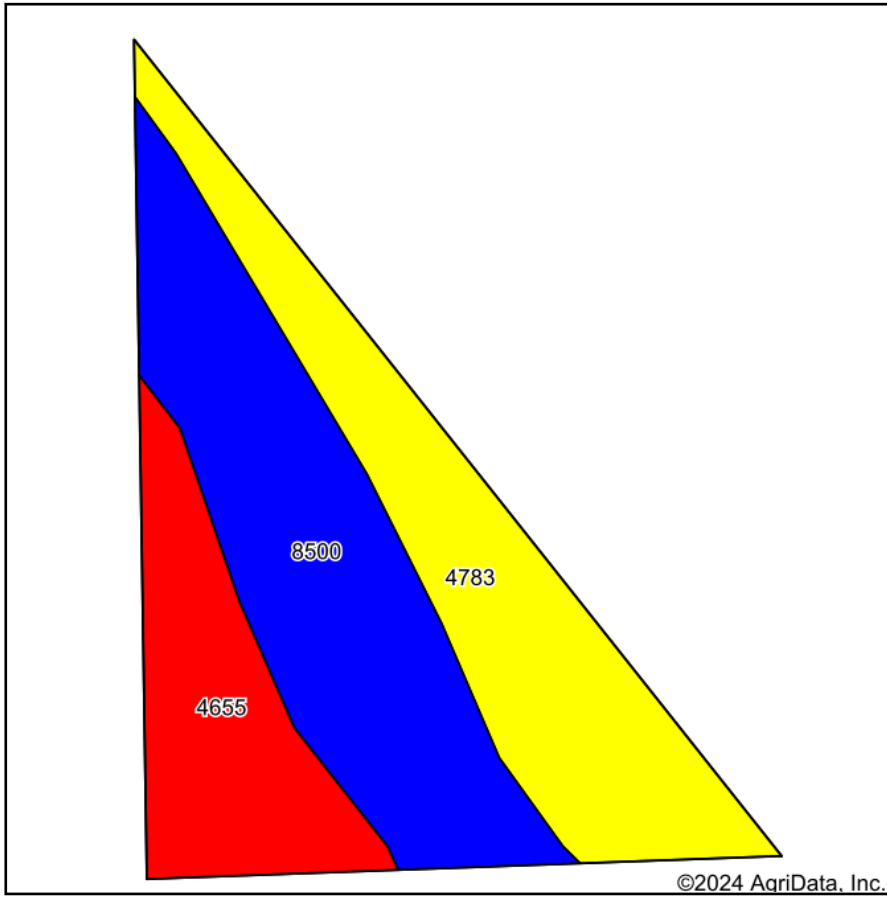

Soils data provided by USDA and NRCS.

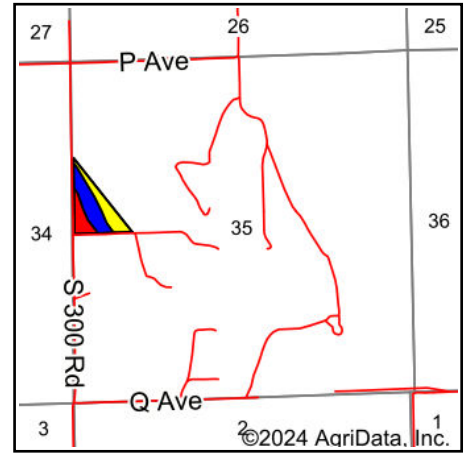



State: **Kansas**
 County: **Morris**
 Location: **35-15S-9E**
 Township: **Township No. 2**
 Acres: **12.2**
 Date: **4/30/2024**

Maps Provided By:

 CUSTOMIZED ONLINE MAPPING
 © AgriData, Inc. 2023 www.AgriDataInc.com

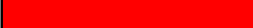

Area Symbol: KS127, Soil Area Version: 20

Code	Soil Description	Acres	Percent of field	Non-Irr Class Legend	Non-Irr Class *c	Irr Class *c
8500	Mason and Reading silt loams, rarely flooded	5.17	42.4%		lw	lw
4783	Tully silty clay loam, 3 to 7 percent slopes	4.35	35.7%		llle	llle
4655	Florence-Labette complex, 2 to 12 percent slopes	2.68	22.0%		Vle	Vle
Weighted Average					2.81	2.81

*c: Using Capabilities Class Dominant Condition Aggregation Method