

Soils Map

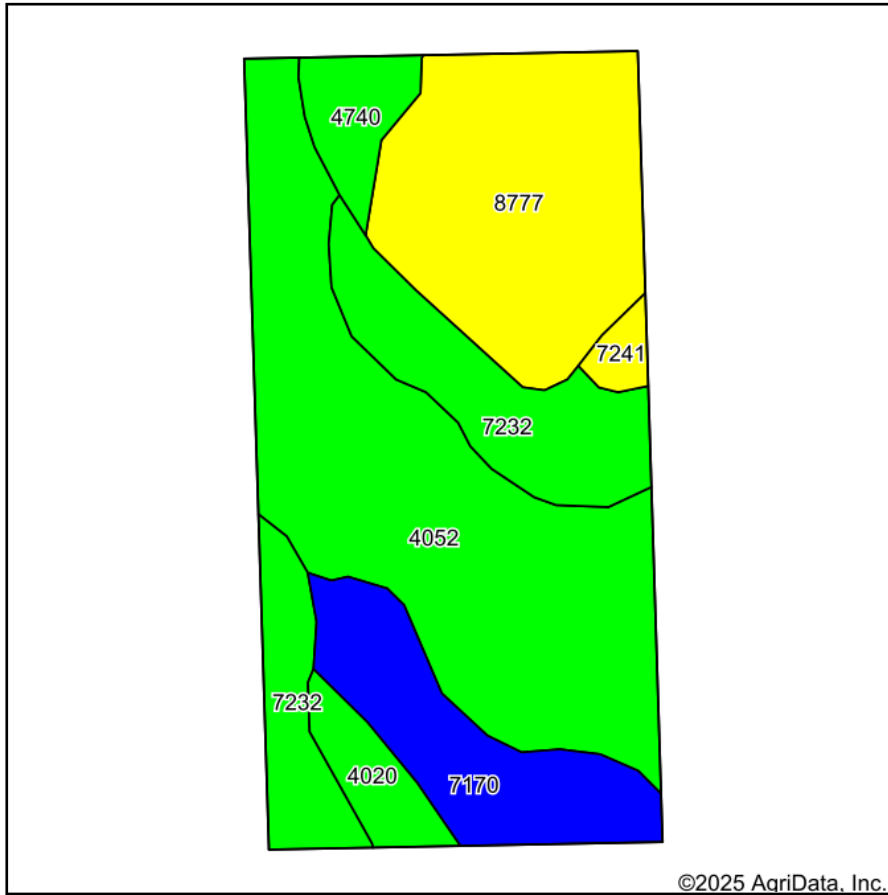

Soils data provided by USDA and NRCS.

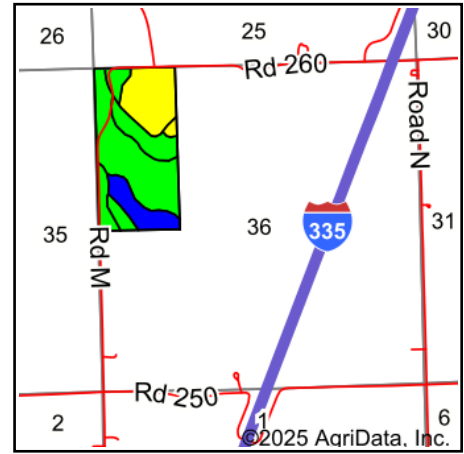

State: **Kansas**
 County: **Lyon**
 Location: **36-17S-11E**
 Township: **Fremont**
 Acres: **80**
 Date: **12/2/2025**

Maps Provided By:

 CUSTOMIZED ONLINE MAPPING
 © AgriData, Inc. 2025 www.AgriDataInc.com



Area Symbol: KS111, Soil Area Version: 24

Code	Soil Description	Acres	Percent of field	Non-Irr Class Legend	Non-Irr Class *c	Irr Class *c
4052	Ivan silt loam, occasionally flooded	30.82	38.5%		Ilw	Ilw
8777	Kenoma silty clay loam, 1 to 3 percent slopes, eroded	18.59	23.2%		Ille	
7232	Elmont silt loam, 1 to 3 percent slopes	13.65	17.1%		Ile	
7170	Reading silt loam, rarely flooded	9.81	12.3%		Iw	Iw
4740	Labette silty clay loam, 1 to 3 percent slopes	3.19	4.0%		Ile	Ile
4020	Chase silty clay loam, occasionally flooded	2.90	3.6%		Ilw	Ilw
7241	Elmont silty clay loam, 3 to 7 percent slopes, eroded	1.04	1.3%		Ille	Ille
Weighted Average					2.12	*-

*c: Using Capabilities Class Dominant Condition Aggregation Method

*- Irr Class weighted average cannot be calculated on the current soils data due to missing data.