

Soils Map

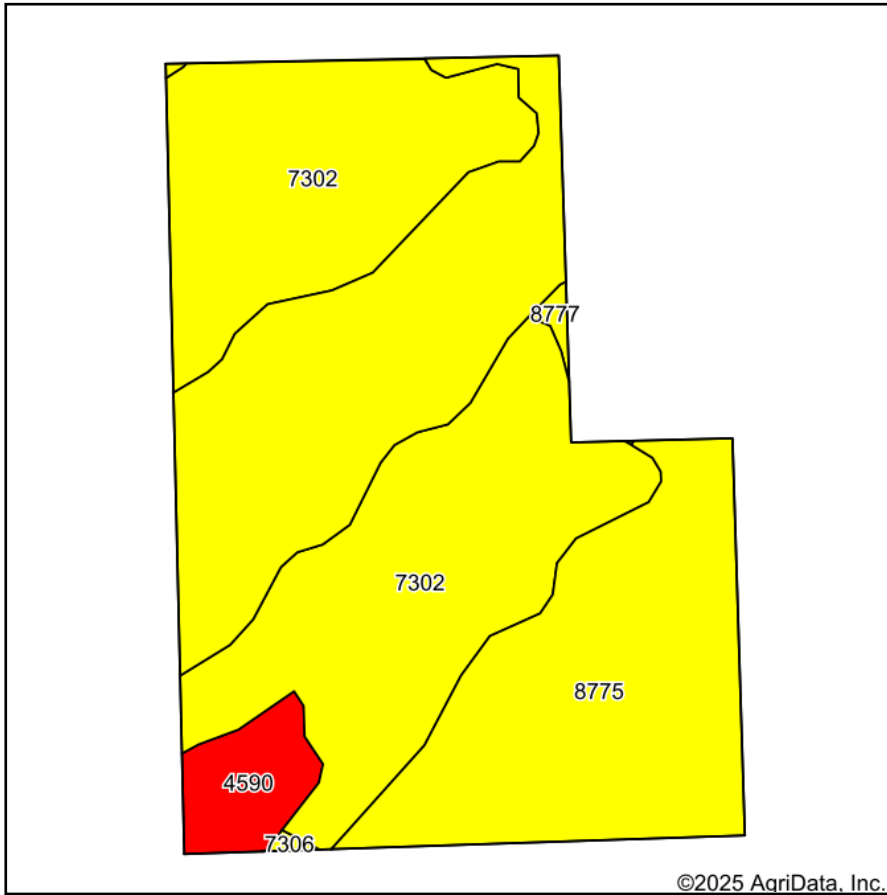

Soils data provided by USDA and NRCS.

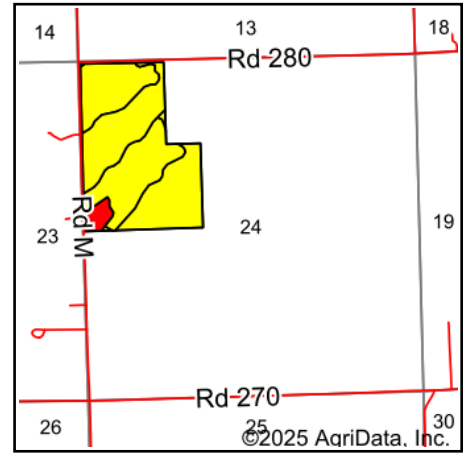

State: **Kansas**
 County: **Lyon**
 Location: **24-17S-11E**
 Township: **Fremont**
 Acres: **96**
 Date: **12/2/2025**

Maps Provided By:

 CUSTOMIZED ONLINE MAPPING
 © AgriData, Inc. 2025 www.AgriDataInc.com



Area Symbol: KS111, Soil Area Version: 24

Code	Soil Description	Acres	Percent of field	Non-Irr Class Legend	Non-Irr Class *c	Irr Class *c
8775	Kenoma silt loam, 1 to 3 percent slopes	48.19	50.2%		IIle	
7302	Martin silty clay loam, 3 to 7 percent slopes	43.38	45.2%		IIle	IIle
4590	Clime-Sogn complex, 3 to 20 percent slopes	3.93	4.1%		Vle	
8777	Kenoma silty clay loam, 1 to 3 percent slopes, eroded	0.36	0.4%		IIle	
7306	Martin silty clay, 3 to 7 percent slopes, eroded	0.14	0.1%		IIle	IIle
Weighted Average					3.12	*-

*c: Using Capabilities Class Dominant Condition Aggregation Method

*- Irr Class weighted average cannot be calculated on the current soils data due to missing data.