

Soils Map

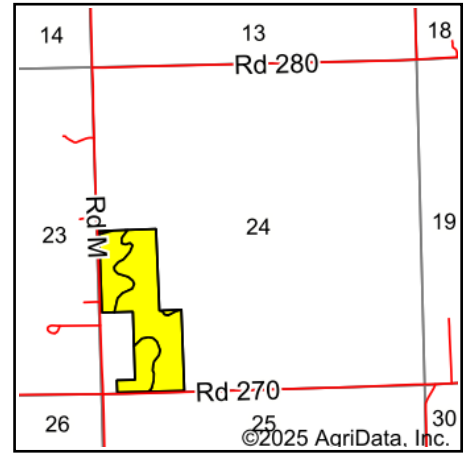
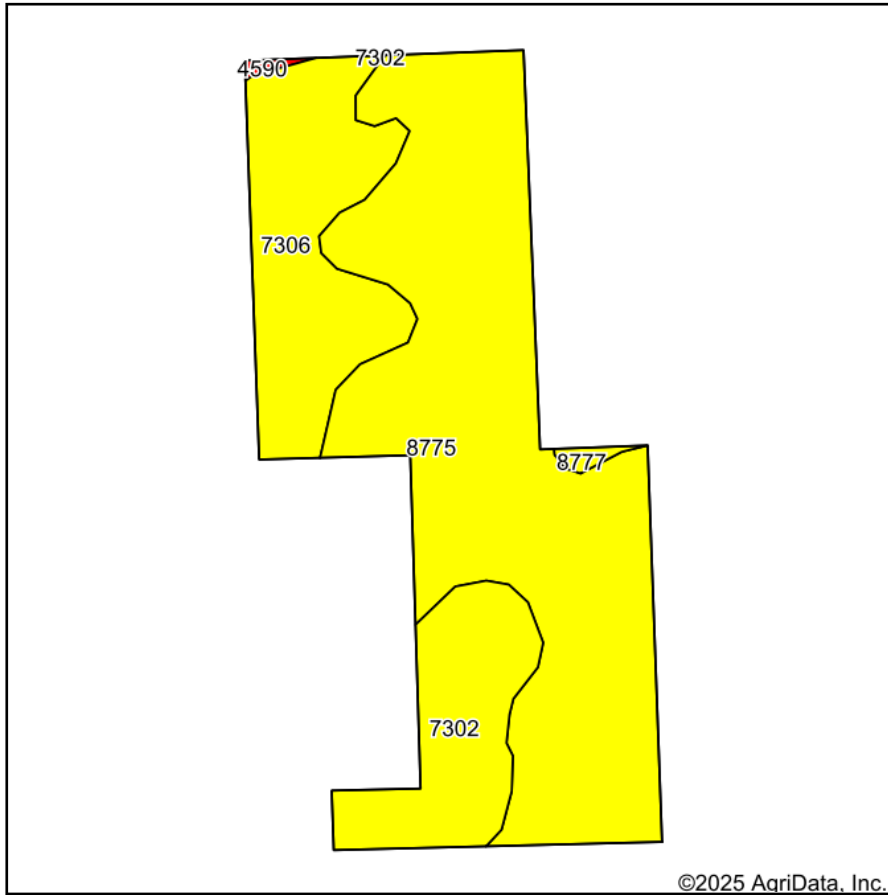

State: **Kansas**
 County: **Lyon**
 Location: **24-17S-11E**
 Township: **Fremont**
 Acres: **54**
 Date: **12/2/2025**

Maps Provided By:

 CUSTOMIZED ONLINE MAPPING
 © AgriData, Inc. 2025 www.AgriDataInc.com



Area Symbol: KS111, Soil Area Version: 24						
Code	Soil Description	Acres	Percent of field	Non-Irr Class Legend	Non-Irr Class *c	Irr Class *c
8775	Kenoma silt loam, 1 to 3 percent slopes	34.40	63.7%		IIIe	
7306	Martin silty clay, 3 to 7 percent slopes, eroded	11.31	20.9%		IIIe	IIIe
7302	Martin silty clay loam, 3 to 7 percent slopes	7.82	14.5%		IIIe	IIIe
8777	Kenoma silty clay loam, 1 to 3 percent slopes, eroded	0.31	0.6%		IIIe	
4590	Clime-Sogn complex, 3 to 20 percent slopes	0.16	0.3%		Vle	
Weighted Average					3.01	*-

*c: Using Capabilities Class Dominant Condition Aggregation Method

*- Irr Class weighted average cannot be calculated on the current soils data due to missing data.