

## Summary

**Parcel ID** 267260000004000  
**Quick Ref ID** R17289  
**Property Address** 1768 ROAD 20  
**Brief Tax Description** S26, T21S, R12E, ACRES 157.7, SE1/4 LESS ROW  
(Note: Not to be used on legal documents)  
**Taxing Unit Group** 136  
**Lot Size (SF)** N/A  
**Acreage** 157.78  
**Property Class** Farm Homesite  
**Zoning** Agricultural  
**Lot Block Subdivision** --  
**S-T-R** 26-21S-12E  
**Deed Book & Page** 0360 - 0538; 0404 - 0587; 2011 - 02570;  
**Neighborhood** Rural Nbhd 840 - Neosho Rapids/Hartford Hinterland



## Owner

**Primary Owner**  
 Young Family Revocable Trust  
 67 Village Pkwy  
 Stevensville, MT 59870-7416

## Lot

Method	Type	AC/SF	Class
Acre	Primary Site - 1	1.70	

## Agricultural Land

Details:			Summary:	
Ag Type	Ag Acres	Ag Soil	Dry Land Acres	
NG	26.03	4570	Irrigated Acres	
NG	8.05	4575	Native Grass Acres	156.08
NG	58.67	4590	Tame Grass Acres	
NG	5.84	4740	<b>Total Ag Acres</b>	<b>156.08</b>
NG	40.88	7301		
NG	16.27	7306		
NG	0.34	7654		

## Residential Information

**Res Type** Single-Family Residence  
**Quality** AV-  
**Physical Condition** AV  
**Year Built** 2005  
**Eff Year** 0  
**MS Style** One Story  
**LBCS Struct** Detached SFR unit  
**No. of Units** 0  
**Total Living Area** 1440  
**Upper Floor Living Area %** 0  
**Main Floor Living Area** 1440  
**CDU** GD  
**Remodel**  
**Arch Style** Ranch  
**Bsmt Type** Walkout - 5  
**Total Rooms** 4  
**Bedrooms** 2  
**Family Rooms** 0  
**Full Baths** 2  
**Half Baths** 1  
**Foundation** Concrete - 2

### Other Building Improvements

Occupancy	Qty	Year Built	Area	Perim	Hgt	Stories
Prefabricated Storage Shed	1	1950	150	50	8	1

**Dwelling Components**

Code	Units	Pct	Quality	Year
Frame, Siding, Vinyl	0	100		
Galvanized Metal	0	100		
Warmed & Cooled Air	0	100		
Automatic Floor Cover Allowance	0			
Plumbing Fixtures(#)	10			
Plumbing Rough-ins(#)	1			
Raised Subfloor (% or SF)	1440			
Single 1-Story Fireplace(#)	1			
Attached Garage (SF)	624			
Garage Finish, Attached (SF)	624			
Total Basement Area (SF)	1440			
Open Slab Porch (SF)	380		3.00	2005
Wood Deck (SF)	380		3.00	2005
Wood Deck (SF) with Roof	384			

**Other Buildings**

Occupancy	Qty	Year Built	Area	Perim	Hgt	Stories
Farm Implement Building	1	1995	2,400	200	14	1
Farm Implement Building	1	2001	840	116	14	1
Lean-to, Farm Utility	1	2001	360	24	10	1
Greenhouse, Hoop, Arch-Rib, Large	1	2017	1,500	160	10	1

**Sales**

Date	Type	Amount	Source	Validity	COV
8/8/2011		\$0			
11/1/1990	Land Only-1	\$16,400	SVQ-8	08 - Excessive Personal Property	001827
11/6/1979		\$0			

**Valuation**

2026 Appraised Value				2025 Appraised Value			
Class	Land	Building	Total	Class	Land	Building	Total
A	\$17,520	\$38,400	\$55,920	A	\$16,750	\$39,730	\$56,480
F	\$22,960	\$258,940	\$281,900	F	\$20,580	\$255,720	\$276,300
<b>Total</b>	<b>\$40,480</b>	<b>\$297,340</b>		<b>Total</b>	<b>\$37,330</b>	<b>\$295,450</b>	<b>\$332,780</b>

**Photos**





### Sketches

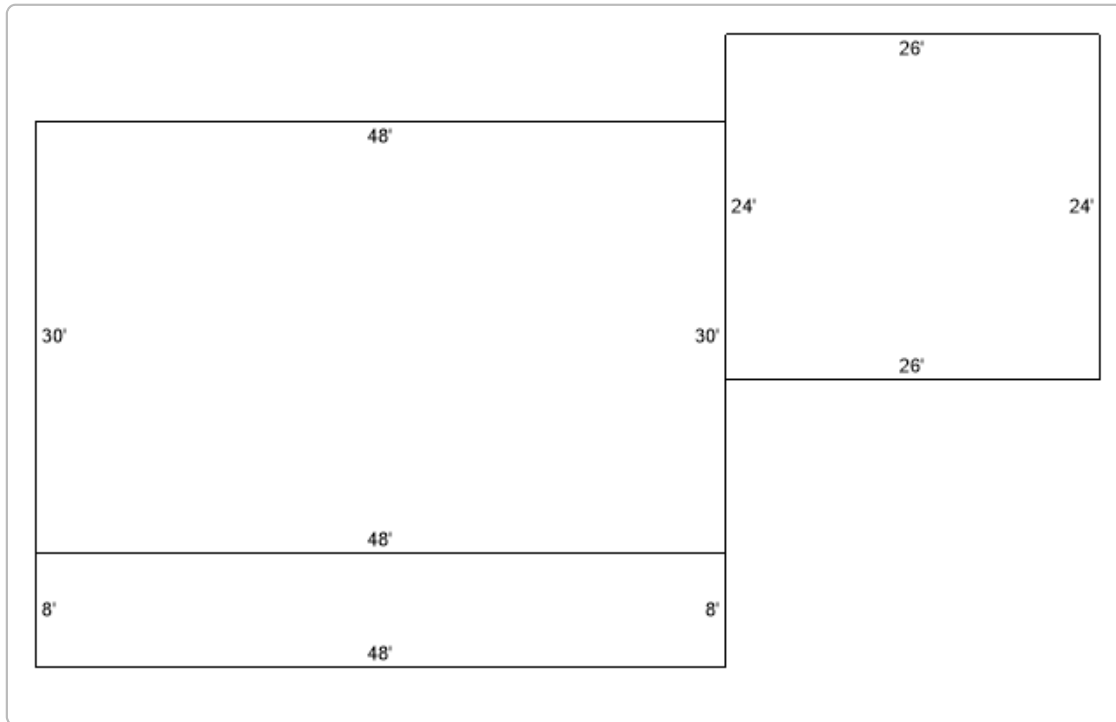

No data available for the following modules: Comp Report Generator (Commercial), Comp Report Generator (Non Res/Com), Commercial Information, SVQ Documents.

No warranty, express or implied, is provided for the data herein, or its use.  
[User Privacy Policy](#) | [GDPR Privacy Notice](#)  
Last Data Upload: 5/21/2026, 12:05:30 PM

[Contact Us](#)

Developed by  
 **SCHNEIDER**  
GEO SPATIAL