

**Summary**

Parcel ID 254200000004000  
 Quick Ref ID R17049  
 Property Address 322 ROAD W  
 Brief Tax Description S20, T21S, R13E, ACRES 157, SW1/4 LESS ROW  
 (Note: Not to be used on legal documents)  
 Taxing Unit Group 130  
 Lot Size (SF) N/A  
 Acreage 157.12  
 Property Class Farm Homesite  
 Zoning Agricultural  
 Lot Block Subdivision --  
 S-T-R 20-21S-13E  
 Deed Book & Page 0388 - 0622; 0394 - 0157; 0218 - 0827; 2013 - 03199;  
 Neighborhood Rural Nbhd 840 - Neosho Rapids/Hartford Hinterland



**Owner**

Primary Owner  
 Gardner, Daniel R & Virginia L; Trust  
 22798 NW 1840th Rd  
 Garnett, KS 66032-8331

**Lot**

| Method | Type             | AC/SF | Class |
|--------|------------------|-------|-------|
| Acre   | Primary Site - 1 | 0.53  |       |

**Agricultural Land**

| Details: |          |         |                | Summary:        |        |
|----------|----------|---------|----------------|-----------------|--------|
| Ag Type  | Ag Acres | Ag Soil | Dry Land Acres | Irrigated Acres |        |
| DR       | 6.36     | 4051    |                |                 | 12.23  |
| DR       | 5.52     | 7232    |                |                 | 21.17  |
| DR       | 0.19     | 7302    |                |                 | 123.19 |
| DR       | 0.16     | 8777    |                |                 | 156.59 |
| TG       | 1.46     | 3890    |                |                 |        |
| TG       | 2.27     | 4051    |                |                 |        |
| TG       | 2.65     | 4590    |                |                 |        |
| TG       | 29.89    | 7232    |                |                 |        |
| TG       | 5.71     | 7302    |                |                 |        |
| TG       | 15.26    | 7306    |                |                 |        |
| TG       | 4.37     | 7654    |                |                 |        |
| TG       | 2.83     | 8775    |                |                 |        |
| TG       | 58.75    | 8777    |                |                 |        |
| NG       | 16.91    | 4051    |                |                 |        |
| NG       | 4.18     | 7232    |                |                 |        |
| NG       | 0.08     | 8777    |                |                 |        |

**Residential Information**

Res Type Single-Family Residence  
 Quality AV-  
 Physical Condition AV  
 Year Built 1880  
 Eff Year 0  
 MS Style Two Story  
 LBCS Struct Detached SFR unit  
 No. of Units 0  
 Total Living Area 2505  
 Upper Floor Living Area % 98  
 Main Floor Living Area 1265  
 CDU AV-  
 Remodel  
 Arch Style Old Style  
 Bsmt Type Partial - 3  
 Total Rooms 8  
 Bedrooms 4  
 Family Rooms 0  
 Full Baths 2  
 Half Baths 1  
 Foundation Stone - 4

| Dwelling Components Code        | Units | Pct | Quality | Year |
|---------------------------------|-------|-----|---------|------|
| Frame, Siding, Vinyl            | 0     | 100 |         |      |
| Composition Shingle             | 0     | 100 |         |      |
| Warmed & Cooled Air             | 0     | 100 |         |      |
| Automatic Floor Cover Allowance | 0     |     |         |      |
| Plumbing Fixtures (#)           | 11    |     |         |      |
| Plumbing Rough-ins (#)          | 1     |     |         |      |
| Raised Subfloor (% or SF)       | 2515  |     |         |      |

| Code  | Units | Pct | Quality | Year |
|---|-------|-----|---------|------|
| Total Basement Area (SF)                    | 316   |     |         |      |
| Wood Deck (SF)                              | 30    |     |         |      |
| Wood Deck (SF) with Roof                    | 78    |     |         |      |
| Enclosed Wood Deck (SF), Knee Wall w/Panels | 225   |     |         |      |
| Enclosed Wood Deck (SF), Solid Wall         | 240   |     |         |      |

**Other Buildings**

| Occupancy             | Qty | Year Built | Area  | Perim | Hgt | Stories |
|-----------------------|-----|------------|-------|-------|-----|---------|
| Barn, General Purpose | 1   | 1900       | 1,536 | 156   | 12  | 1       |
| Outbuildings          | 1   | 1960       | 10    | 44    | 8   | 1       |
| Barn, General Purpose | 1   | 1900       | 936   | 124   | 16  | 1       |
| Hog Nursery           | 1   | 1980       | 3,400 | 268   | 8   | 1       |
| Grain Storage         | 1   | 1900       | 576   | 96    | 14  | 1       |
| Farm Utility Shelter  | 1   | 1975       | 3,168 | 248   | 16  | 1       |

**Valuation**

| 2026 Appraised Value |                 |                  |                  | 2025 Appraised Value |                 |                  |                  |
|----------------------|-----------------|------------------|------------------|----------------------|-----------------|------------------|------------------|
| Class                | Land            | Building         | Total            | Class                | Land            | Building         | Total            |
| A                    | \$23,720        | \$6,130          | \$29,850         | A                    | \$22,700        | \$6,620          | \$29,320         |
| F                    | \$12,660        | \$160,440        | \$173,100        | F                    | \$11,920        | \$149,480        | \$161,400        |
| <b>Total</b>         | <b>\$36,380</b> | <b>\$166,570</b> | <b>\$202,950</b> | <b>Total</b>         | <b>\$34,620</b> | <b>\$156,100</b> | <b>\$190,720</b> |

**Photos**



**Sketches**

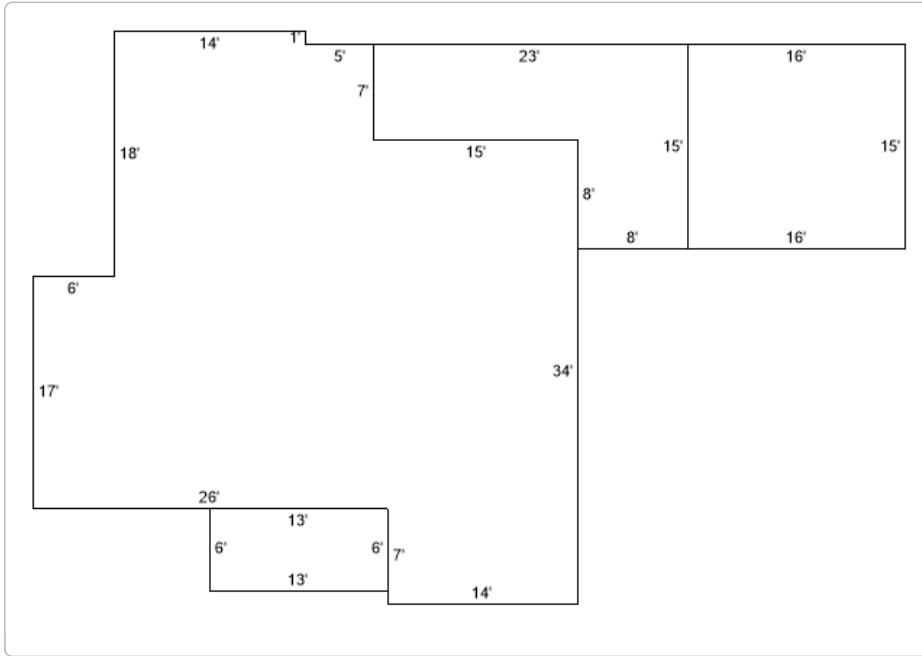

No data available for the following modules: Comp Report Generator (Commercial), Comp Report Generator (Non Res/Com), Commercial Information, SVQ Documents.

No warranty, express or implied, is provided for the data herein, or its use.  
[User Privacy Policy](#), | [GDPR Privacy Notice](#)  
Last Data Upload: 5/19/2026, 8:05:04 AM

Contact Us

